

*Edward L. Pine
Middle School
2010-2011*



*Student
Handbook/Planner*



**EDWARD L. PINE
MIDDLE SCHOOL
“Home of the Patriots!”**

STUDENT HANDBOOK 2010-2011

Edward L Pine Middle School
4800 Neil Road
Reno, Nevada 89502
(775) 689-2550
(775) 689-2539

Brad Boudreau
Principal

Arch Ruth
Vice Principal

Pine's Heritage:

Pine Middle School was named after Dr. Edward L. Pine, a well known and highly regarded Nevadan. He contributed to the community and to education through his participation in civic affairs and fraternal organizations. He was the longest serving Washoe County School Board Member, and served the Nevada Legislature in the area of education.

Our school colors are red, white, and blue.

Our school symbol is the Patriot.

Patriots stands for: Proud, Ambitious, Tactful, Responsible, Impartial,
Optimistic, Tolerant, and Successful
And that is what we hope for each of you.

This agenda belongs to:

NAME _____

ADDRESS _____

CITY/TOWN _____ ZIP CODE _____

PHONE _____

STUDENT NO. _____

Pine's Building Map

Ground Floor

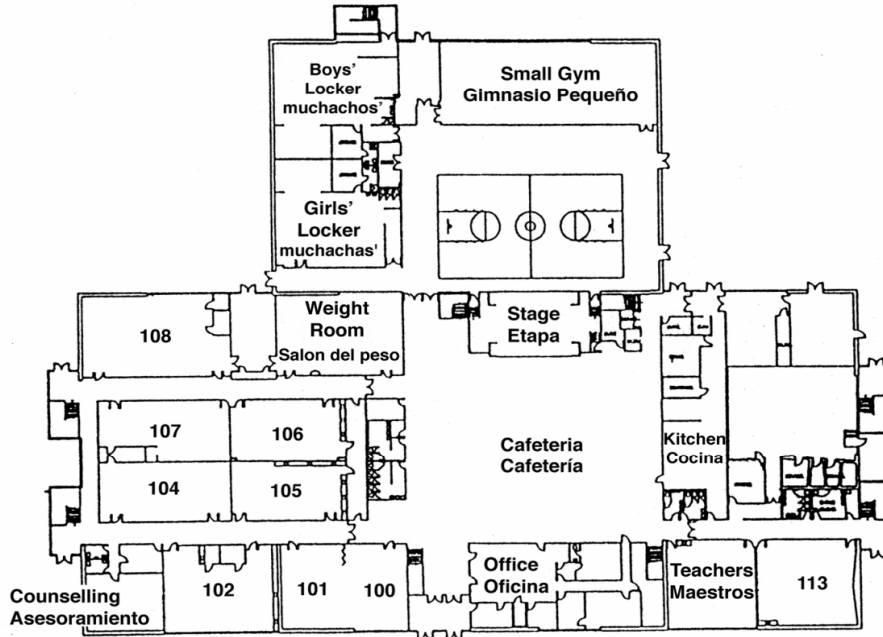

Second Floor

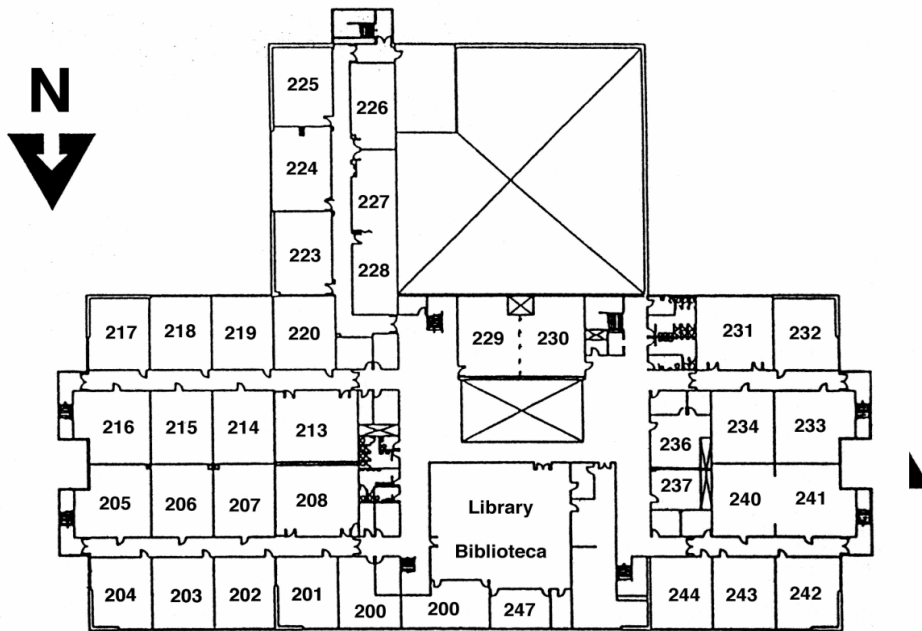

My Schedule

Quarter 1

Period	Subject	Teacher	Room
0			
1			
2			
3			
4			
5			
6			

Quarter 2

Period	Subject	Teacher	Room
0			
1			
2			
3			
4			
5			
6			

Quarter 3

Period	Subject	Teacher	Room
0			
1			
2			
3			
4			
5			
6			

Quarter 4

Period	Subject	Teacher	Room
0			
1			
2			
3			
4			
5			
6			

**PINE MIDDLE SCHOOL
2010-2011
Bell Schedule**

Regular Start Schedules

Monday, Tuesday, Friday

Module	Time
O/Advisory	7:30 - 7:50 (20)
A	7:54 - 8:45 (51)
B	8:49 - 9:40 (51)
Nutrition Break	9:40-9:51 (11)
C	9:51 - 10:42 (51)
6th/7th Grade	
Lunch 10:45 – 11:15 (30)	D 10:46 - 11:37 (51)
D 11:19 – 12:10 (51)	Lunch 11:40 - 12:10 (30)
E	12:14 - 1:05 (51)
F	1:09 - 2:00 (51)

Wednesday (45 minute Early- Release)

Module	Time
O/Advisory	7:30 - 7:40 (10)
G	7:45 – 9:05 (80)
Nutrition Break	9:05 – 9:15 (10)
H	9:15 – 10:35 (80)
6th/7th Grade	
10:35 – 11:05 (30) Lunch	10:40 – 11:20 (40) Enrichment (H)
11:10 – 11:50 (40) Enrichment (H)	11:20 – 11:50 (30) Lunch
I	11:55 – 1:15 (80)

Thursday

Module	Time
O/Advisory	7:30 - 7:40 (10)
G	7:45 – 9:20 (95)
Nutrition Break	9:20 – 9:30 (10)
H	9:30 – 11:05 (95)
6th/7th Grade	
11:05 – 11:35 (30) Lunch	11:10 – 11:50 (40) Enrichment (H)
11:40 – 12:20 (40) Enrichment (H)	11:50 – 12:20 (30) Lunch
I	12:25 – 2:00 (95)

PINE TELEPHONE NUMBERS

School Phone Number: 689-2550

School Fax Number: 689-2539

Attendance Line: 689-2556

Espanol: 689-2553

Office Hours:

7:00 AM – 3:30 PM Monday through Friday

PRINCIPALS' MESSAGE

Welcome to Pine Middle School, home of the Patriots! Built in 1975, we are pleased to offer you a beautiful facility in which to learn and grow. A well educated and caring faculty welcomes the opportunity to meet your needs, educationally, socially, and emotionally, which makes us confident that you will enjoy and succeed here at Pine.

Middle school can be an exciting time in your life and if you follow these helpful hints, we guarantee your success:

- Become involved with some of the many extracurricular activities and/or clubs that are offered at Pine.
- Familiarize yourself with the school's rules, regulations, and procedures and FOLLOW THEM.
- Develop study skills that will help your academic growth in middle school and prepare you for high school.

Be proud of your school, always representing it in a positive manner.

Pine Middle School is YOUR school. Take care of it; take care of each other; and lastly, protect our PRIDE in the community by being outstanding PATRIOTS.

Brad Boudreau
Principal

Arch Ruth
Assistant Principal

STUDENTS' CODE OF ETHICS

As a student Pine Middle School, our students will strive to demonstrate the five qualities of moral character fundamental to human conduct:

Integrity requires that our students stand up for what is right instead of just trying to go along with the group.

Respect requires that our students treat themselves and others with honor and respect, and obey school rules and the laws of our country.

Justice requires fairness to others as well as to self, balancing praise and blame in accordance with actions.

Responsibility means our students are responsible for their own actions and the effects they have on themselves and on others.

Courage refers to facing mental or physical dangers and having the strength to face, rather than, deny, those dangers.

GENERAL INFORMATION

TIME OF ARRIVAL AND DEPARTURE: School starts at 7:30 a.m. and ends at 2:00 p.m. There will be a 45 minute early release on Wednesdays for staff development. School will be released at 1:15 on Wednesdays. There is no supervision for students before 7:00 a.m. unless they are enrolled in an early bird class. Students are to be off campus by 2:20 p.m. unless participating in a supervised activity.

BEFORE CLASS IN THE MORNING: Students may go to a teacher's classroom for extra help beginning at 7:15 a.m., if they have a pass from their teacher or a note from a parent. At 7:15 a.m., students who are not eating or working on class work will be asked to wait in the back play area. If students are not with a teacher for extra help, they are required to wait in the back play area or the cafeteria. Students may not wait for friends outside of the building. Additionally, once students have arrived on campus, they are not to leave the campus until the end of the school day, or signed out by an authorized person.

TELEPHONES: Office telephones are business phones and may be used by students for emergencies only. Students will be called out of class only for an emergency, as determined by a school administrator. **Phone messages will not be delivered to students as there is no way to verify a person's identity by phone.**

PASSING PERIODS: Although a bell will signal the end of each class period, only the classroom teacher will dismiss students. As students change classes, they are expected to move quickly and quietly and "*walk to the right*" to help others who are also moving to class.

PERSONAL BELONGINGS: Students who bring personal belongings to school are responsible for the security and safety of those items. The school is not responsible for any items lost or stolen from anywhere within the school during a school day, from the school at night, or over a weekend. This includes bicycles, calculators, band instruments, clothing, confiscated nuisance, or any school items, etc.

PERSONAL COMMUNICATION DEVICES: The use by students of personal communication devices such as **cell phones**, pagers/beepers or other similar electronic communication devices is prohibited during the instructional day. As long as use is not disruptive, students may use these devices before or after school.

1. These devices must remain off during instructional time including passing periods.
2. Students who violate this policy will be disciplined as provides for in the Pine Middle School Positive Behavior System/Progressive Discipline Plan.

Pine Middle School students are responsible for the safe keeping of their personal cell phones.

TEXTBOOKS: Textbooks are provided to students by the school district free of charge. However, all library books and textbooks remain the property of the school. Students will be charged for lost or damaged books. Any lost or stolen books must be paid for before another book is issued. Textbooks are the property of the Washoe County School District and are loaned to students on the following conditions:

1. To be used only by the students to whom issued and not transferred to any other student.
2. To be returned when requested or at the time of withdrawal if the pupil leaves before the end of the school year.

If the book is damaged in excess of reasonable wear or is lost, a pupil must pay for the replacement.

BACKPACKS: To maximize classroom space and eliminate safety hazards, backpacks are not allowed in classrooms. All backpacks and purses must be stored in lockers during the instructional day. Students may retrieve items from their backpacks before school, after lunch, and at the end of the school day.

LOCKERS: School lockers remain the property of the school, and school authorities have a responsibility to examine the contents of those lockers for reasons of health, safety, and security. Acceptance on the part of a student assigned a locker is acknowledgment of the privilege retained by the Washoe County School District to examine the contents of that locker whenever determined appropriate.

LOCKER GUIDELINES:

1. School lockers are not secure. Do not leave money or high value items in your locker.
2. Locker combinations are strictly private information and must not be given to anyone.
3. When your locker does not function properly, report it immediately to the deans' office.
4. Never leave your locker without making sure you have locked it.
5. Pine Middle School is not responsible for any items missing from your locker.

Report any theft or locker damage immediately to the deans' office.

P.E. LOCKERS: To provide maximum security for clothes and personal items during physical education, all students will be issued a physical education locker with a lock. Students are responsible for keeping the lockers and locks in good condition.

Students may only use the locker during their assigned physical education period.

Students are not to share locker combinations with unauthorized students and may not use personal locks on the lockers.

LOST AND FOUND: Lost and found is located near the front office. All unclaimed personal articles are given to a charitable organization at the end of each semester.

INSURANCE: The school does not carry insurance for your child and has no responsibility for accidental injury. Proof of insurance is required to try out for all school/district sponsored sports/activities.

ACCIDENT AND ILLNESS: It is imperative that current home and emergency telephone numbers be on file at the school. If your telephone number changes, please notify the registrar at 689-2550. Every accident occurring at school or a school sponsored event must be immediately reported to the adult in charge and/or the Clinical Aide. A student who is too ill to remain in class should obtain a pass from the teacher then report to the Health Office so parents may be notified. State law does not allow school health personnel to diagnose illness or injury. Parents should check with their family physician if they have a question about their child's health.

STUDENT STORE: The student store, located in the cafeteria, will stock paper, pencils, pens, and various other items needed in school. It will be open at lunch for purchases. Physical Education uniforms and other fees may be paid to the banker in the front office.

FEES FOR MATERIALS: In some classes, students may be charged for materials required to construct "special projects" which will be taken home. Students may also be required to bring materials necessary to complete projects. Any fees charged will reflect actual cost of the materials used by the students.

TRANSPORTATION

BUS TRANSPORTATION: Bus transportation is provided for all students living two or more miles from the Pine Middle School campus. Students must ride the same bus to and from school; they are not allowed to ride another student's bus.

Students who ride school buses must abide by all school and transportation department rules. Inappropriate behavior on the bus which jeopardizes any student's safety and well being will not be tolerated. It is important students comply with any reasonable request from the bus driver while riding the bus. Should a student behave contrary to the safety rules, the driver has the option to issue a bus citation. The WCSD bus transportation rules are explained to the students by the bus drivers and are posted on each bus.

BICYCLES: Bicycles are not allowed on school sidewalks except for the sidewalk next to the tennis courts on the north side of the building. All bicycles must be parked and locked in the bicycle area in a manner that is consistent with the design of the bicycle

rack. Students must provide a personal lock for their bikes. Pine Middle School is not responsible for damaged or stolen bicycles. Bicycle riders are to use the designated sidewalk upon arrival and departure. Misuse of bicycles on school grounds can result in the loss of bicycle privileges.

Students are not to ride bicycles anywhere else on campus before or after school except the direct route to the bicycle area.

Roller Blades, Skateboards, Scooters, Roller Skates, or any Motorized Vehicle: For the safety of students, staff, parents, and visitors, these types of transportation are not allowed on campus.

PARKING LOT: In an ongoing efforts to provide the safest campus possible for our students, the parking lot will be closed from 7:15 a.m. to 7:30 a.m. and from 2:00 p.m. to 2:30 p.m. Plan to drop-off and pick up students on the sidewalks that surround the perimeter of the school. Please use the sidewalks nearest the school so students do not need to cross in front of traffic.

ACTIVITIES

ASSEMBLIES: Assemblies will be scheduled throughout the year. Students must be seated in their assigned section with their teacher. The privilege of attending is limited to those students who demonstrate positive behavior.

CLUBS/ACTIVITIES: Students are strongly encouraged to participate in activities by joining clubs or enjoying intramural sports. Some clubs may include, but are not limited to: chess club, homework club, technology, math counts, future city, etc. Information about the various clubs/activities will be available at the beginning of the school year.

COMPETITIVE SPORTS: Prior to trying out for cross-country, basketball, volleyball, soccer, or track, students must pass a sports physical, provide proof of insurance, submit a liability waiver, and meet the academic requirements. Packets with the appropriate forms will be available from the coach prior to tryouts.

FIELD TRIPS: A field trip permit and a medical release form signed by a parent or guardian are required to participate in a field trip. However, participation in school-sponsored activities outside the regular classroom is a privilege not a right. Students with a history of not following directions or who have other discipline problems are not eligible to participate. Out of state trips require a minimum of a 2.0 grade point average with no U's, F's, or required parent conferences during the year.

ATTENDANCE/ABSENCES FROM SCHOOL

Please keep in mind these guidelines with regard to attendance:

If a student is absent from school, the parent or guardian should call the attendance line and inform the office at 689-2556 between 7:00 a.m. and 9:00 a.m. Your parent or guardian may call earlier and leave a message on the answering machine. If the school does not receive a call, we will phone parents to check on your absence.

Pre-arranged absences for funerals, family emergencies, etc. can be made by calling the school or bringing a note.

If you must leave school for any reason during the day, please bring a note to the office in the morning to obtain a street pass. When you return from your appointment, you must check in with the office window before returning to class.

It is your responsibility to check with all teachers regarding work missed while absent. We encourage you to fill out the *Phone Contact* page (back of the Planner) and call other fellow students to find out about homework assignments. **Make-up work must be completed in the length of time equal to the number of days missed.** We ask that you and your parents do not call the school for homework or assignments **unless** you will be out for **three or more days**.

The Nevada Revised Statute 392.122 is the basis for the WCSD Attendance Policy and Procedure 5113. NRS 392.122 states that the Board of Trustees shall establish a minimum attendance requirement for promotion to the next grade or earning credit. The WCSD Board of Trustees has established a policy requiring 90% attendance for promotion to the next grade or earning credit. The emphasis of the attendance policy is on the importance of keeping students in school and providing access to the curriculum. During the 2005 Legislature, NRS 392.122 was revised. Because of this change in statute, the WCSD Board of Trustees adopted a policy that considers a medical absence as an approved/excused absence if the student completes the make-up work.

The attendance policy is for all students at the elementary and secondary levels. There are some differences between the two levels because of the manner in which credit is earned at the secondary level. The major points of the policy are as follows:

Absences that do NOT count against the 90%.

10 Circumstance absences per year for elementary and middle school students or 5 Circumstance absences per each semester for high school students do not count if approved by the site administrator.

Examples of these types of absences are:

Religious
Family business
Pre-arranged
Legal
Personal business
Emergencies
Bereavement

Medical absences do not count against the 90%. Beginning with the 2005-2006 school year, medical absences do not count against the 90% attendance requirement. There are two types of codes for medical absences. One code designates a medical absence which has documentation provided by a health care professional. The other medical absence is coded to indicate that the parent/guardian has affirmed that the absence is of a medical nature. The school has the right to request a parent conference if medical absences become excessive and there is no documentation of a health concern provided by a medical professional. It is extremely important that parents provide a note from a medical professional if available and always notify the school of an absence due to a medical reason.

It should be noted that parents must send a note or call the school regarding any absence. This must be done within three days after the student returns to school. Of course, calls or notes in advance are always appreciated. Pre-arranged absences must be requested at least 2 school days in advance of the absence and should be requested earlier than 2 days in advance if the absence is for an extended period of time.

There are certain types of absences that DO count against the 90% attendance rule.

- Any absence that is not verified by a parent counts against the 90%.
- Any Domestic absence counts against the 90%.
- A Domestic absence is any absence beyond the 10 (elementary/middle school) or 5 per semester (high school) Circumstance absences.
 - Absences that are within the parent's control also count as Domestic absences.

Examples of these types of absences are:

- **Staying home to care for siblings**
- **Didn't feel like coming to school**
- **Any truancy issue**
- **Sleeping in too late**

Missed instruction at the middle and high school level is marked when the student is late or leaves at any time during the class period.

Make-up work must be provided for any absence, but it is the student's responsibility to request the make-up work in advance or on the first day s/he returns to

class. Because it is impossible to make-up some in-class assignments, coursework of a similar nature may be given. It is the student's responsibility to turn in all make-up class work at the designated deadline. Failure to complete the make-up work within the designated deadline will result in no credit received for the make-up work. If your child has exceeded the 90% requirement, you may ask for a review of the absences. A Request for Administrative Review form may be obtained from the school. Please note that in order for any absence to be considered for review, the make-up work must have been completed per District policy. The principal or his designee will review the absences and notify the parent of the decision. Students who attend less than 90% of the year or course will be retained or not earn credit.

If you have any questions regarding the attendance policy, contact your child's school. Attendance is a shared responsibility and concern of students and parents/guardians with the assistance and support of school staff and the community. Let's all work together to get our children in school and make every day count!

TARDINESS: Students are to be seated in their classrooms prior to the bell. Persistent and continued tardiness may result in detention, loss of privileges, or suspension from school. Tardies are cumulative for each quarter. Any student who is more than 30 minutes late to class will be counted absent for that classroom period.

HOMEWORK REQUEST: Homework may be requested if a student is out of school more than three (3) days. Notify the front office by the second day of the absence, and the work will be ready for pickup the following afternoon. The work must be picked up within 24 hours.

MAKE-UP WORK: Following each absence, it is the student's responsibility to contact each teacher for make-up work. Each teacher has an area designated to identify daily assignments (wall calendar, notebook, etc). Each teacher will determine the amount of time given to complete make-up work; however, students must request work within three (3) days following an absence.

STREET PASSES: Pine Middle School is a closed campus. Students are not to leave campus for lunch or for any part of the school day. Students who are off campus during the school day for any reason must carry a street pass. A street pass may be obtained from the front office by presenting a signed note from a parent/guardian. Most passports are issued for dental or medical appointments but other activities deemed important by parents/guardians may also be allowed. To expedite the process and release of students, it is requested that all notes be presented to the attendance office before 7:30 a.m. on the day of the passport request. Parent/guardian must report to the attendance

office and produce proper identification for student release.

WITHDRAWAL/TRANSFERS: When a student is moving from the Pine Middle School attendance zone, he/she must obtain a *Pupil Release and Transfer Form* from the registrar. The parent/guardian must come to the office and request the withdrawal. If the student is present in school, the student will take this form to each teacher to receive a current grade and to return all textbooks and library books. All fines and fees must be paid before grades and records can be transferred to another school.

Positive Behavior System DISCIPLINE

We, as an Administration, Faculty, and Staff of Pine Middle School, are proud of the students who attend our school. A majority of our students are conscientious and well behaved. It is our goal to promote a positive learning experience for our students. To this end Pine Middle School is establishing a Positive Behavior Systems throughout the school.

The essence of good behavior is RESPECT— respect for *authority*, respect for *others*, respect for *self*, and respect for *rules*. It is an attitude which begins at home, is reinforced at school, and is applied throughout life.

Our Patriot PRIDE matrix instructs and guides our students in what positive behaviors are expected throughout the school.



Patriot PRIDE



Expectations	Language	Attitudes	Behaviors	Character	Attitudes	Skills	Attitudes	Character
Be Safe	Use safe language. Health and safety. Safety. Do not use profanity.	Safe. No profanity. No profanity.	Walk. Run. No running. No running.	Responsible. Responsible. Responsible.	Responsible. Responsible. Responsible.	Responsible. Responsible. Responsible.	Responsible. Responsible. Responsible.	Responsible. Responsible. Responsible.
Be Respectful	Safe. In line. No profanity. No profanity.	Respect. Respect. Respect.	Keep. Keep. Keep.	Follow. Follow. Follow.	Follow. Follow. Follow.	Follow. Follow. Follow.	Follow. Follow. Follow.	Follow. Follow. Follow.
Be Responsible	Responsible. Responsible. Responsible.	Responsible. Responsible. Responsible.	Responsible. Responsible. Responsible.	Responsible. Responsible. Responsible.	Responsible. Responsible. Responsible.	Responsible. Responsible. Responsible.	Responsible. Responsible. Responsible.	Responsible. Responsible. Responsible.
Be a Problem Solver	Problem. Problem. Problem.	Problem. Problem. Problem.	Problem. Problem. Problem.	Problem. Problem. Problem.	Problem. Problem. Problem.	Problem. Problem. Problem.	Problem. Problem. Problem.	Problem. Problem. Problem.

Classroom Behavior Problems: Teachers will handle minor disciplinary offenses with private interviews, corrective assignments, detention, a phone call to parents, parent conferences, and/or referral to the administration. Offenses include classroom interruptions, tardiness to class, language, or disruptive behavior. Each teacher's discipline procedures are tied to the Positive Behavior Systems established at Pine Middle School.

Campus Behavior Problems: Any staff member may take corrective action or write a referral for a student's misbehavior on campus. Such offenses may be using inappropriate language, not following dress code, fighting, etc.

Referrals: A student may be referred to the administration for major violations of behavioral expectations. One or more of these consequences may be expected when a student receives a referral:

- A conference with an administrator, dean, or counselor
- Referral to Positive Behavior Intervention Committee
- Detention (after-school or lunch time)
- Friday Night Lights (School Beatification Program)
- In-house suspension
- A required parent conference
- Suspension from school
- Referral to a Behavioral Intervention Program
- Recommendation for expulsion from school

DISCIPLINE REGULATIONS: Pine Middle School's discipline rules/regulations come from Nevada Law and Washoe County School District regulations/guidelines. Clear and blatant violations of these behaviors while at school, at school related activities, or on the way to or from our school will result in disciplinary action. Some violations may require us to call upon law enforcement agencies to deal with the violation. The following behaviors are subject to immediate action by the school:

1. Smoking on or around our school campus
2. Theft or burglary
3. Defacing school property
4. Throwing items (to include food) at others
5. Immoral, lewd, or disorderly conduct to include saying or writing obscene words or symbols
6. Fighting/threatening bodily harm toward anyone
7. Insubordination and refusal to cooperate with any WCSD employee
8. Wearing gang related clothing, displaying gang signals or being involved with gang activity
9. Using racial or derogatory actions/statements
10. Possession or use of alcohol or drugs

COMMIT THE CRIMES LISTED AND YOU WILL BE SUBJECT TO EXPULSION, ALSO YOU WILL BE PROSECUTED TO THE FULLEST EXTENT OF THE LAW:

ARSON

The willful burning of any part of the school building or property therein.

BATTERY

Battery and/or assault to a school district employee at school or related activities.

CONTROLLED SUBSTANCES

Selling of controlled substances or substances represented as controlled substances.

WEAPONS

Possession, use, transmittal, or concealment of ANY weapon is prohibited. Weapons are defined as firearms, knives, explosives, inflammable materials, or any other item that may cause bodily injury or death.

*

NOTE: FIGHTING, ASSAULT, BATTERY OR OTHER AGGRESSIVE BEHAVIORS WILL RESULT IN A MINIMUM THREE-DAY SUSPENSION.

Control of Dangerous and Anti-Social Behavior

The law charges every teacher and principal (NRS 393.278, NRS 332.60) with maintaining order and discipline among students, and provides that students who do not comply with reasonable rules may be suspended or expelled (NRS 392.030).

Action taken to control or correct undesirable student behavior should take individual circumstances into account but must always be most concerned for the safety and educational welfare of the majority of students.

We wish to make it clear that verbal and physical harassment of another student is considered a very serious offense. No one at Pine will have to tolerate bullies or other students who verbally threaten or intimidate. Verbal harassment has many disguises. We will not tolerate students who specialize in having a laugh at another person's expense. Such immature and insensitive behavior may result in an office referral, parent contact, and possible suspension from school.

If a student is experiencing harassment of any kind immediately contact the Principal, Assistant Principal, the Dean of Students, a counselor or any teacher. Harassment can only be addressed and eliminated if we all work together.

SECRET WITNESS

The Washoe County Secret Witness Program is a safe and anonymous way to report any crimes that you see. The Secret Witness phone number is **329-6666**. Call that number between 7-5 during the weekdays to report a crime anonymously. Sometimes the program can offer cash rewards. Call if you know someone is going to bring a gun or any weapon, if someone has drugs or selling drugs, if you know someone is tagging up the a school, if someone is planning to harm another student, if you see harassment or bullying going on, or anything you think is important to the safety or protection of our schools in Washoe County, especially Pine Middle School. You are an important part of the process in protecting you and your fellow classmates.

PINE MIDDLE SCHOOL
UNIFORM DRESS CODE

Pine Middle School does require all students to wear school uniforms beginning the 2009-2010 school year.

Why are students required to wear school uniforms?

In reviewing research on school uniforms and looking at our own data, we felt this move would improve the climate of our school and reduce incidences of behaviors related to dress, such as gang involvement, bullying and other inappropriate behaviors. Pine Middle School believes this will help our students resist peer pressure, concentrate on their studies, lower clothing costs for families, and help us quickly recognize non-students on campus.

What does the uniform consist of?

- Students are required to wear khaki or black colored pants, knee length shorts, skirts, shorts, skorts or capris in the same colors are acceptable as well. All must be sized to fit about the waist and pants must extend to the top of the shoe. They must be free of holes and slits and can not be pegged at the bottom. Shorts, skirts, skorts and capris must be minimum fingertip length and hemmed.
- A black or white short/long sleeved polo shirt is required. Shirts must be sized to fit and tucked in. No oversized shirts are allowed.
- All clothing with the exception of school purchased clothing must be free of slogans, logos, insignias, brand names, trademarks, messages, gang insignias, wording, pictures, studs, jewels and chains. Contrasting colors must be worn. No black pants with black shirts are allowed.
- Sweaters, non-hooded sweatshirts and vests may be worn over the polo shirt. These must be solid colored white, khaki or black. The collars of the polo shirt must be clearly visible and worn on the outside of the sweater, sweatshirt or vest.
- Jackets/coats, mittens/gloves, caps/hats and scarves must be removed in the building and stored in student lockers prior to entering classrooms and office buildings.
- Solid white or black tee shirts may be worn underneath the polo shirt.
- On **Fridays Only**: Students also have the option to wear Pine Middle School team shirts or sweatshirts that they have personally earned or purchased through a school activity, sport or club.
- If a belt is worn, the belt and belt buckle must adhere to the above restrictions regarding logos, brand names, etc. and must be black, khaki or white in color. The tail of the belt may not extend more than three inches from the buckle.
- Shoe choices will remain the discretion of students and their parents; however, the WCS

dress code guidelines remain intact. Shoes with soles must be worn. All shoes requiring shoelaces must be laced and tied appropriately. Only black and white shoelaces will be allowed. No solid red or blue shoes will be allowed.

- If socks are worn, they must be black, khaki or white in color.
- Accessories such as jewelry and make-up will still be allowed, again in accordance with WCSD dress code policy. However, no colored wristbands, neckbands, bandanas, head bands, or “doo” rags are allowed.

Where can the uniform be purchased, and how much will it cost?

- The purchase location of khaki or black colored shirts, pants and shorts will be left to the discretion of students and their parents or guardians. There are many reasonably priced options at stores such as Old Navy, Wal-Mart, Target, and JC Penny and where other schools purchase school uniforms. If you are making a purchase through Lands End, the Pine Preferred School number is: 900132812.
- Optional items will also be available for purchase at the school site. Prices may vary and will be displayed at the school.

Will there be financial assistance available for students who cannot afford to buy their own uniform?

- Yes, there will be limited assistance for students who are in need. If you are in need of assistance with the cost of the uniform, please contact the counseling office or Mr. Boudreau at 689-2550. Uniforms of students moving on have also been donated and “recycled” for students.

Any items not specifically covered by this policy shall fall in accordance with WCSD dress code policy and are subject to the review of the administration.

Students in violation of the uniform policy will be referred to the Dean of Students' Office for disciplinary action. All violations will be documented in the student's disciplinary file and parents will be notified. Appropriate disciplinary action will be taken with habitual offenders, as it becomes an issue of insubordination.

If you have any questions regarding the uniform policy please contact the school at 689-2550.

HARASSMENT: Student harassment, physical and verbal abuses, including any racially or sexually derogatory statements/actions made by one person to another is prohibited and will result in disciplinary action.

HANDS OFF POLICY: Students are required to keep their hands to themselves. This applies to horseplay, play fighting, public displays of affection, and other inappropriate or aggressive behavior.

NUISANCE ITEMS: Items not directly associated with the educational program are not to be brought to school. These items include, but are not limited to, radios, tape recorders, electronic games, laser pens, pagers, water guns, roller blades, skateboards, yo-yos, water balloons, rubber bands, pets or stuffed animals, and trading cards. Students found in possession of such items will have the items confiscated and may be subject to disciplinary actions. Parents must pick up confiscated items from the deans' office.

GUM AND FOOD: Eating food (including candy) or drinking a beverage, with the exception of water, is permitted only in the cafeteria. Students who take food outside of the cafeteria may face disciplinary action. **There is not to be any gum chewing anywhere on campus.** Gum is a nuisance item that may deface school property.

PUBLIC DISPLAY OF AFFECTION: Holding hands, embracing, kissing, or other inappropriate acts of affection are not permitted on campus and may be subject to disciplinary action. There is a time and place for everything. School is the time for academic instruction and for practicing proper behavior.

ADVISORY

Advisory is a vital element of your education. It will be used as quality time spent with one of your team teachers and some of your teammates. Our teachers are using advisory as a time to get to know you and become your advocate here at Pine. Academic, social, and emotional issues will be discussed regularly during this time. Your advisory teacher will be the person you will be advised to go to with questions and problems that you might encounter throughout the year. He/she will be the one helping you get your locker, learning to open it, and maintaining regular cleaning of your locker. Attending this class is an important tool for your success at Pine Middle School.

CAFETERIA

The Pine cafeteria is a vital part of our school. Two meals are served daily--breakfast and lunch.

BREAKFAST: Items for breakfast are available each day in the cafeteria. Breakfast is served daily from 7:00 am – 7:15 am. Students may purchase cereal, rolls, juice, and other breakfast items.

NUTRITION BREAK: There is an extended passing period in the morning that allows students eat a brief snack. Students generally, bring items to snack on, however, snack items are available for purchase through the cafeteria and snack carts.

LUNCH: There are two lunch periods each day. Students may purchase the daily lunch combo, or a la carte items such as a slice of pizza or a taco.

Please go to your locker before going to the cafeteria, put your books away and get your coat if it's a cool day. You will not be allowed back to your locker after you eat because other classes are in session.

Pine is a closed campus. You may not leave campus at lunch unless you have a street pass from the office.

After eating lunch, students are to go directly outside after being dismissed so the cafeteria can be cleaned for the next lunch. You may not take food outside with you.

Cutting in line, saving places in line, or buying food for friends is not allowed.

Each student is responsible for clearing his/her trash.

If you eat breakfast at Pine, breakfast is served from 7:00 am until 7:15 am. At 7:15 am all students who are not eating or working on school-work will be asked to wait in the play area until the first bell.

**NO FOOD OR DRINK, WITH THE EXCEPTION
OF WATER, IS TO BE
CARRIED OUT OF THE CAFETERIA!**

FREE OR REDUCED LUNCH: Families that qualify for the federal free or reduced lunch program may obtain an application from the kitchen manager. The cafeteria supervisor manages this program and any questions concerning the program may be handled through her. (689-2550)

COUNSELING: The Counselors' Office is for the benefit of every student in the school. Students wishing to talk to a counselor are encouraged to do so. Request forms to meet with your counselor are available in the counseling office. Counselors are available to meet with students to discuss academic, social, or career concerns.

Students are encouraged to become acquainted with the counselors because they can be a great deal of help. Parents are also encouraged to contact the counselors. In certain situations, a parent-teacher-student-counselor conference provides valuable insight into problems the student may be experiencing in school.

REPORTING STUDENT PROGRESS: Report cards are issued to students every nine weeks. The final report card of the year is mailed home. Students receive two grades for every course, an academic grade and a citizenship grade. At the end of each semester, students also receive a grade for their

semester exams. Student progress reports are mailed home the fifth week of each quarter for students not performing satisfactorily.

Academic Grades:

- A = Excellent Achievement
- B = Above Average Achievement
- C = Average Achievement
- D = Below Average
- F = Failing Work

Citizenship Grades:

- A = Excellent Behavior
- B = Above Average Behavior
- C = Average Behavior
- D = Needs Improvement
- F = Unacceptable Behavior

PROMOTION POLICY: A pupil in grade 6 must complete with a passing grade one semester in mathematics and one semester in reading or English for promotion to seventh grade.

A pupil in grade 7 must complete with a passing grade one semester in mathematics and one semester in reading or English for promotion to eighth grade.

A pupil in grade 8 must complete three semesters with a passing grade in mathematics and English and must complete two semesters with a passing grade in science and social studies during the seventh and eighth grade years for promotion to high school.

AWARDS AND RECOGNITION

Pine Middle School students are rewarded for academic excellence, attendance, and behavior that represents our core values of being safe, respectful, responsible, and a problem solver. Pine is proud to acknowledge and reward students by implementing a variety of positive recognition programs.

Patriot PRIDE Award (Student of the Month Recognition): The Patriot PRIDE is the most coveted award presented monthly to select students. Teachers select students who demonstrate exceptional performance at school. A special luncheon with the principal is held in their honor.

Straight A's and/or Straight A's in Citizenship: All students who earn straight A's and/or straight A's in citizenship will be recognized and rewarded with specially planned activities.

Honor Roll: Pine publishes a quarterly honor roll. In order to qualify for the honor roll, a student must have a 3.5 academic GPA. Courses that are graded S/U are not included in the computation.

8th Grade Awards Night: At the end of the school year, awards are presented to 8th grade students at the Annual Awards Night program. Special recognition is given to students who excel in academics and other activities.

Academic Awards: At the Annual Awards Night program, eighth grade students who have maintained a 3.0 to 4.0 GPA for eighth grade receive certificates signed by the President of the United States.

Additional Recognition Programs: Students who demonstrate behaviors that are a part of our core beliefs will be eligible to receive PINE BUCKS daily. These PINE BUCKS make students eligible for select purchases in the student store and daily/weekly rewards such as FAST PASSES to lunch, extra time in the Learning Center, RESERVED SEATING at lunch, or prize raffles from community school sponsors.

HOMEWORK: Homework reinforces class work through practice and extension. It is an integral part of the program at Pine Middle School. Students can expect to have homework in all major subjects and may have homework in many electives.

LOST AND FOUND: When items are found on campus they are taken near the front office. Clothing is held in the deans' office for two weeks and then is donated to charity. Please check with the front office at the end of the day.

PARENTS

TELEPHONE MESSAGES: Occasionally parents request that a telephone message be delivered to their child. However, school personnel cannot accept such requests by phone since there is no way to verify the legal parent/guardian leaving the message. Should an emergency arise necessitating the need to contact a student, parents are asked to come to the office and provide appropriate identification.

CAMPUS VISITS: Parent/Guardians are welcome and encouraged to visit the school and their child's teachers. Parents/Guardians may attend classes with their child but they must make visitation arrangements at least 24 hours in advance. Arrangements are made through the counseling office. All visitors must report to the principal's office immediately upon arrival and obtain a visitor's pass.

DELIVERIES: Classrooms will not be interrupted for the delivery of messages to students unless there is an emergency. No flowers, singing telegrams, etc. will be delivered during school hours.

PARENT VOLUNTEERS: It is important for students to know that their parents are taking an active role in their education by participating in activities with students, other parents, and staff. Parent volunteers play a key roll at Pine Middle School. If you are available to lend a helping hand, please contact the front office and request a parent volunteer form.

PARENT CONFERENCES: Parents are encouraged to make appointments for conferences with teachers, counselors, or administrators by calling the counseling

office at 689-2550. Teacher conferences should be scheduled at least a day in advance.

PARENT IDENTIFICATION: Please bring your driver’s license or other photo identification when you come to school to pick up your child during the school day. We need a positive identification prior to releasing a student.

SAFETY AND SECURITY

HALL PASSES: In order to leave the classroom, students must have a hall pass from their teacher.

FIRE DRILLS/EVACUATION DRILLS:

Fire/Evacuation drills are required monthly by law and are an important safety precaution. Exit routes are posted in every classroom. When the alarm sounds, it is essential to clear the building by the prescribed route as quickly as possible. Students are to remain outside the building until the signal (the orange flag) is given to return inside.

SHELTER-IN-PLACE/LOCKDOWN DRILLS:

Pine MS will conduct three (3) Shelter-in-Place Drills during the school year to instruct pupils on appropriate procedures in the event of an emergency.

LOITERING: To maintain maximum safety, students are to report to the cafeteria or back play area as they arrive on campus each day. Students are not to loiter in parking lots, or on properties adjacent to the Pine Middle School campus either before or after school. Once students arrive at school, they must remain on campus. During after-school activities, students not authorized to be on campus may be cited for trespassing.

Students are responsible for all materials issued to them (textbooks, musical instruments, etc.) during the school year.

LEARNING CENTER

The Pine MS Learning Center is the information center of the school. Our library has a wealth of resources, including thousands of books, magazines, electronic resources, and multiple student computers. Students are welcome to use the library from 7:30 to 2:30. The Learning Center may be available later as a part of our 21st Century after-school program. The learning center program is integrated with the school’s educational and instructional goals. Teachers schedule their classes to come to the learning center for research projects, activities, reading, and book check out. Students may check out up to 5 books at a time. Washoe County School District policy holds students responsible for the care and return of their library books.

Students will receive their Pine ID cards at the beginning of the school year, after school pictures are taken. This card is the identification needed for students to checkout books from the library and is a

vital resource throughout the year for numerous activities and special programs at Pine.

SCHOOL WEB SITE

The school web site, located at <http://www.washoecountyschools.org/pine/> is a useful tool for locating information about Pine Middle School. School hours, important dates, clubs, and a variety of databases can be found here.

ACCEPTABLE USE POLICY

In order to use the school computers, every student on campus must have completed an Acceptable Use Policy (AUP) signed by both themselves and their parent. This form needs to be completed upon initial enrollment at our school and kept as a record on campus throughout the student’s enrollment on campus. Violation of the AUP may result in student’s not having access to the school computers.

INFINITE CAMPUS ONLINE

Infinite Campus Online can be accessed through the school website. It provides up to date attendance and grade reports.

STATEMENT OF NON-DISCRIMINATION:

Neither Pine Middle School nor the Washoe County School District will knowingly discriminate against any person on the basis of race, creed, color, national or ethnic origin, sex, handicap, or age.

DRUG FREE SCHOOL: We are dedicated to provide you with a school environment that is safe, secure, and drug free. With your help, we can. Should a student be found in possession of marijuana or other drugs, we will make every effort to remove him or her from the regular school setting.

DELAYED STARTS/WEATHER DELAYS

Occasionally, the weather in Washoe County may effect the time when classes begin. Families need to monitor the district’s website at <http://www.washoe.k12.nv.us/> , listen to radio or TV for information regarding any delayed starts. Additionally, WCSD will make a ConnectEd call to families about news related to the school or delayed starts.

Delayed Start Schedules- i.e. Weather Delays

Monday, Tuesday, Friday

Three-Hour Delayed Start:

Module	Time
A	10:30 to 10:57 (27)
B	11:00 to 11:27 (27)
C	11:30 to 11:57 (27)
6 th /7 th Grade	8 th Grade
lunch 11:57 to 12:27	D 12:00 to 12:30 (30)
D 12:30 to 1:00 (30)	lunch 12:30 to 1:00
E	1:03 - 1:30 (27)
F	1:33 - 2:00 (27)

Two-Hour Delayed Start:

Module	Time
A	9:30 to 10:07 (37)
B	10:11 to 10:48 (37)
C	10:52 to 11:29 (37)
6 th /7 th Grade	8 th Grade
lunch 11:29 to 11:59	D 11:32 to 12:09 (37)
D 12:02 to 12:39 (37)	lunch 12:09 to 12:39
E	12:42 – 1:19 (37)
F	1:23 - 2:00 (37)

One-Hour Delayed Start:

Module	Time
A	8:30 to 9:17 (47)
B	9:21 to 10:08 (47)
C	10:12 to 10:59 (47)
6 th /7 th Grade	8 th Grade
lunch 10:59 to 11:29	D 11:02 to 11:49 (47)
D 11:32 to 12:19 (47)	lunch 11:49 to 12:19
E	12:22 – 1:09 (47)
F	1:13 - 2:00 (47)

Wednesday, Thursday

Three-Hour Delayed Start:

Module	Time
G	10:30 – 11:15 (45)
H	11:20 – 12:05 (45)
6 th /7 th Grade	8 th Grade
12:05 – 12:35 (30) Lunch	12:05 – 12:35 (30) Enrichment (H)
12:40 – 1:10 (30) Enrichment (H)	12:40 – 1:10 (30) Lunch
I	1:15 – 2:00 (45)

Two-Hour Delayed Start:

Module	Time
G	9:30 – 10:35 (65)
H	10:40 – 11:45 (65)
6 th /7 th Grade	8 th Grade
11:45 – 12:15 (30) Lunch	11:45 – 12:15 (30) Enrichment (H)
12:20 – 12:50 (30) Enrichment (H)	12:20 – 12:50 (30) Lunch
I	12:55 – 2:00 (65)

One-Hour Delayed Start:

Module	Time
G	8:30 – 9:55 (85)
H	10:00– 11:25 (85)
6 th /7 th Grade	8 th Grade
11:25 – 11:55 (30) Lunch	12:00 – 12:30 (30) Enrichment (H)
12:00 – 12:30 (30) Enrichment (H)	12:00 – 12:30 (30) Lunch
I	12:35 – 2:00 (85)

**ATHLETIC AND PERFORMANCE CLUB
ELIGIBILITY**

Competition is scheduled with other middle schools for cross-country, basketball, wrestling, volleyball, soccer and track. Ineligibility for athletics and/or suspension from games results from: chronic absences, inappropriate behavior, the possession of tobacco, alcohol, or a controlled substance on or off campus or receiving more than one “F” in citizenship. Please carefully review each sport’s participation guidelines.

Students who take part in a school athletic team are not allowed to participate in/try-out for a performance club (i.e. school play/drama) if their seasons overlap.

W.C.S.D. Middle School Athletics Eligibility

All middle school students will be able to try out for a middle school sports program regardless of their previous or current grades.

In order to participate in a contest (incl.: scrimmages with other schools), students must meet both of the following criteria:

Establish a 2.0 GPA in both academics and citizenship. Have no “F’s” in academic or citizenship. Grades will be checked the Friday before the first week of scheduled contests.

Once the above criteria is met, students will have a grade check a minimum of every two weeks from the Friday of the initial grade check through the completion of the season.

Grades can be checked more frequently than every two weeks to establish a student’s eligibility.

The 2.0 GPA grade check for academics and citizenship and the check for no “F’s” in academics and/or citizenship is not a cumulative check. It is a measure of the student’s performance over the last two-week period of time.

The 1st semester 9th grade pupil will be eligible for athletic competition during the first semester (unless 3 week grade check indicates otherwise) and must follow all other Washoe County School District and NIAA regulations.

All information in this handbook was current at the time of publication. Any and all changes will be provided and referenced on our school web site.

TEACHER EMAIL ADDRESSES

ARZOIAN, PAULA
parzoian@washoe.k12.nv.us
BOUDREAU, BRAD
bdboudreau@washoe.k12.nv.us
CHILDREE, DEBBIE
dchildree@washoe.k12.nv.us
CHRISTMAN, SANDI
schristman@washoe.k12.nv.us
CONKLIN, JOHN
jconklin@washoe.k12.nv.us
CRITES, DIANA
dcrites@washoe.k12.nv.us
DALE, LAURA
ldale@washoe.k12.nv.us
DAMON, KAREN
kedamon@washoe.k12.nv.us
FAENZA, PATRICK
pfaenza@washoe.k12.nv.us
FAGAN, JENCIE
jfagan@washoe.k12.nv.us
FAHEY, JENNIEFR
jfahey@washoe.k12.nv.us
FORD, CYNTHIA
cford@washoe.k12.nv.us
GABBART, FAY
fgabbart@washoe.k12.nv.us
HALLSTROM, CAREYN
challstrom@washoe.k12.nv.us
HOWARD, DAVID
dhoward@washoe.k12.nv.us
IRIGOIN, SHYLE
sirigoin@washoe.k12.nv.us
ISMARI, MICHAEL
mismari@washoe.k12.nv.us
KAISER, SUSAN
skaiser@washoe.k12.nv.us
KLOCK, ATHENA
aklock@washoe.k12.nv.us
KNOBBE, MITCH
mknobbe@washoe.k12.nv.us
KORENIK, BETT
bkorenik@washoe.k12.nv.us
LATONA, MINDA
mlatona@washoe.k12.nv.us
MACKIN, TIM
tmackin@washoe.k12.nv.us
MANGUM, JAMES
jmangum@washoe.k12.nv.us
MCALPINE, ANN
amcalpine@washoe.k12.nv.us
MCBRIDE, CHRIS
cmcbride@washoe.k12.nv.us
MCKEMY, MIKE
mmckemy@washoe.k12.nv.us
MENTEER, MONJU
mmenteer@washoe.k12.nv.us
MORTIMORE, KIRK
kmortimore@washoe.k12.nv.us
OLSON, BONNIE
bolson@washoe.k12.nv.us

TEACHER EMAIL ADDRESSES

OLSON, MAJORIE
mtolson@washoe.k12.nv.us
O'NEILL, MIKE
mjoneill@washoe.k12.nv.us
RASMUSSEN, PER
prasmussen@washoe.k12.nv.us
ROBINSON, ERIN
erobinson@washoe.k12.nv.us
ROCHA, LORNA
lrocha@washoe.k12.nv.us
ROUNDS, NICOLE
nrounds@washoe.k12.nv.us
RUTH, ARCH
aruth@washoe.k12.nv.us
SAIBINI, KIM
ksaibini@washoe.k12.nv.us
SANTOEMMA, JOHN
jsantoemma@washoe.k12.nv.us
SASS, SCOTT
ssass@washoe.k12.nv.us
SCALZI, RON
rscalzi@washoe.k12.nv.us
SEARLES, CARRIE
csearles@washoe.k12.nv.us
SMITH, BENN
bsmith@washoe.k12.nv.us
TAMOL, ELLEN
etamol@washoe.k12.nv.us
TILLIS, ROSIE
rtillis@washoe.k12.nv.us
TORGERSON, TERESA
ttorgerson@washoe.k12.nv.us
WARREN, MELODY
mwarren@washoe.k12.nv.us
WATSON, NANCY
nwatson@washoe.k12.nv.us
YOUNG, MARY ALICE
myoung@washoe.k12.nv.us

2010-2011 Athletics Schedule

Cross Country Schedule

Tryouts Tuesday, Sept. 7th

Thursday, September 23, 2010
<u>Pine</u> , Billingshurst, Depoali at Pine
Thursday, September 30, 2010
<u>Shaw</u> , Pine, O'brien at Shaw
Thursday, October 7, 2010
<u>Swope</u> , Clayton, Pine, Sparks at Dick Taylor Park
Tuesday, October 12, 2010
<u>Sparks</u> , All Schools Invitational, at Shadow Mountain
Host school is underlined.

Boys' Basketball

Tryouts: January 3

Date and Time	Teams	8th grade site	7th grade site
Tues., Jan. 18th 2:45pm - B team	Pine v. Swope	Pine	Swope
Thurs., Jan. 20th 2:45pm - B team	Pine v. Traner	Pine	Traner
Mon., Jan. 24th 2:45pm - B team	Shaw v. Pine	Shaw	Pine
Thurs., Jan. 27th 2:45pm - B team	Pine v. Mendive	Pine	Mendive
Mon., Jan. 31st 2:45pm - B team	Depoali v. Pine	Depoali	Pine
Thurs., Feb. 3rd 2:45pm - A team	Swope v. Pine	Swope	Pine
Mon., Feb. 7th 2:45pm - A team	Traner v. Pine	Traner	Pine
Thurs., Feb. 10th 2:45pm - A team	Pine v. Shaw	Pine	Shaw
Mon., Feb. 14th 2:45pm - A team	Mendive v. Pine	Mendive	Pine
Thurs., Feb. 17th 2:45pm - A team	Pine v. Depoali	Pine	Depoali

Girls' Basketball

Tryouts: October 14

Date and Time	Teams	8th grade site	7th grade site
Thurs., Oct. 28th 2:45pm - B team	Pine	bye	bye
Mon., Nov. 1st 2:45pm - B team	Clayton v. Pine	Clayton	Pine
Thurs., Nov. 4th 2:45pm - B team	Pine v. Dilworth	Pine	Dilworth
Mon., Nov. 8th 2:45pm - B team	O'Brien v. Pine	O'Brien	Pine
Tues., Nov. 9th 2:45pm - B team	Pine v. Vaughn	Pine	Vaughn
Tues., Nov. 16th 2:45pm - B team	Traner v. Pine	Traner	Pine
Thurs., Nov. 18th 2:45pm - A team	Pine v. Sparks	Pine	Sparks
Tues., Nov. 23rd 2:45pm - A team	Pine	bye	bye
Tues., Nov. 30th 2:45pm - A team	Pine v. Clayton	Pine	Clayton
Thurs., Dec. 2nd 2:45pm - A team	Dilworth v. Pine	Dilworth	Pine
Mon., Dec. 6th 2:45pm - A team	Pine v. O'Brien	Pine	O'Brien
Tues., Dec. 7th 2:45pm - A team	Vaughn v. Pine	Vaughn	Pine

Volleyball

Tryouts Tuesday, Feb. 22

Date and Time	Home	Visitor	Location
Tuesday, March 8, 2:45	Pine	Billinghurst	Pine
Thursday, March 10 2:45	Shaw	Pine	Shaw
Tuesday, March 15, 2:45	Pine	Mendive	Pine
Thursday, March 17, 2:45	Depoali	Pine	Depoali
Tuesday, March 22, 2:45	Swope	Pine	Swope
Thursday, March 24, 2:45	Billinghurst	Pine	Billinghurst
Tuesday, March 29, 2:45	Pine	Shaw	Pine
Thursday, March 31, 2:45	Mendive	Pine	Mendive
Tuesday, April 5, 2:45	Pine	Depoali	Pine
Thursday, April 7, 2:45	Pine	Swope	Pine

Wrestling

Tryouts Tuesday,
Feb. 22

Date and Time	Home	Visitor	Location
Tuesday, March 8, 2:45	Billinghurst	Pine	Billinghurst
Thursday, March 10 2:45	Pine	Shaw	Pine
Tuesday, March 15, 2:45	Mendive	Pine	Mendive
Thursday, March 17, 2:45	Pine	Depoali	Pine
Tuesday, March 22, 2:45	Pine	Swope	Pine
Thursday, March 24, 2:45	Pine	Billinghurst	Pine
Tuesday, March 29, 2:45	Shaw	Pine	Shaw
Thursday, March 31, 2:45	Pine	Mendive	Pine
Tuesday, April 5, 2:45	Depoali	Pine	Depoali
Thursday, April 7, 2:45	Swope	Pine	Swope

Track and Field

Tryouts: April 18, 2011

Thursday, May 5, 2011

Pine	O'Brien	Depoali		at Galena HS
-------------	---------	---------	--	--------------

Tuesday, May 10, 2011

Clayton	Pine	Swope	Sparks	at McQueen HS
----------------	------	-------	--------	---------------

Tuesday, May 17, 2011

BDB,	Depoali	Pine		at McQueen
-------------	---------	------	--	------------

Thursday, May 19, 2011

Swope, Clayton, Pine				at Reno HS
-----------------------------	--	--	--	------------

Soccer

The soccer schedule for the 2010-2011 school year has not been set at the time that this planner went to print.

Patriot PRIDE



Expectations	<i>Cafeteria</i>	<i>Hallways</i>	<i>Lockers</i>	<i>Outside</i>	<i>Bathroom</i>	<i>Bus</i>	<i>Assembly</i>	<i>Classroom</i>
Be Safe	Walk at all times. Hands and feet to yourself. Stay in designated areas.	Walk on the right.	Keep locker only for yourself.	Stay within defined boundaries. Care for equipment.	Sanitize hands.	Follow safety rules.	Move in an orderly manner.	Keep aisles clear and sit properly. Use materials for their intended purpose. Keep hands and feet to yourself. Practice good hygiene.
Be Respectful	Stay in line, no cutting. Use an inside voice.	Quietly keep moving. Use appropriate language.	Keep locker clean.	Follow staff instructions.	Flush the toilet. Keep area clean.	Follow the driver's instructions.	Listen while presenter is talking.	Listen and follow all directions. Be kind and positive. Treat others as you want to be treated.
Be Responsible	Have lunch number or money ready. Always clean your area. Practice good table manners.	Have your planner or pass visible at all times. Arrive to class on time.	Plan ahead for locker trips.	Keep all areas clean. Seek help when needed. Return all equipment.	Report problems. Return to class promptly.	Be at the bus stop on time.	Show school pride.	Come to class prepared to learn with appropriate materials. Complete your own work and turn it in on time. Put forth your best effort.
Be a Problem Solver	Assist in keeping the peace.	Assist in keeping the peace.	Assist in keeping the peace.	Respect personal space.	Help conserve supplies.	Assist in keeping the peace.	Assist in keeping the peace.	Be helpful. Be an active team member.

2010-2011 Traditional School Calendar

July 2010							No School on Shaded Days
S	M	T	W	TH	F	S	
				1	2	3	
4	5	6	7	8	9	10	
11	12	13	14	15	16	17	
18	19	20	21	22	23	24	
25	26	27	28	29	30	31	Number of Student Days=0

January 2011							No School on Shaded Days
J	M	T	W	TH	F	S	
						1	Jan 3: Classes Resume
2	3	4	5	6	7	8	Jan 17: Martin Luther King Jr's Birthday
9	10	11	12	13	14	15	Jan 21: End of Grading Period
16	17	18	19	20	21	22	
23	24	25	26	27	28	29	Number of Student Days =20
30	31						

August 2010							No School on Shaded Days
S	M	T	W	TH	F	S	
1	2	3	4	5	6	7	Aug 30: First Day of School
8	9	10	11	12	13	14	
15	16	17	18	19	20	21	
22	23	24	25	26	27	28	
29	30	31					Number of Student Days = 2

February 2011							No School on Shaded Days
S	M	T	W	TH	F	S	
		1	2	3	4	5	
6	7	8	9	10	11	12	Feb 21: President's Day
13	14	15	16	17	18	19	
20	21	22	23	24	25	26	
27	28						Number of Student Days =19

September 2010							No School on Shaded Days
S	M	T	W	TH	F	S	
			1	2	3	4	Sept 8: Labor Day
5	6	7	8	9	10	11	September 24: Count Day
12	13	14	15	16	17	18	
19	20	21	22	23	24	25	
26	27	28	29	30			Number of Student Days=21

March 2011							No School on Shaded Days
S	M	T	W	TH	F	S	
		1	2	3	4	5	March 25: End of Grading Period
6	7	8	9	10	11	12	
13	14	15	16	17	18	19	
20	21	22	23	24	25	26	
27	28	29	30	31			Number of Student Days =23

October 2010							No School on Shaded Days
S	M	T	W	TH	F	S	
					1	2	
3	4	5	6	7	8	9	Oct 20: End of Grading Period
10	11	12	13	14	15	16	Oct 29: Nevada Day
17	18	19	20	21	22	23	
24	25	26	27	28	29	30	Number of Student Days =20
31							

April 2011							No School on Shaded Days
S	M	T	W	TH	F	S	
					1	2	April 11-15: Spring Break
3	4	5	6	7	8	9	
10	11	12	13	14	15	16	
17	18	19	20	21	22	23	
24	25	26	27	28	29	30	Number of Student Days =16

November 2010							No School on Shaded Days
S	M	T	W	TH	F	S	
	1	2	3	4	5	6	
7	8	9	10	11	12	13	Nov 2: District Professional Development Day
14	15	16	17	18	19	20	
21	22	23	24	25	26	27	Nov 11: Veteran's Day
28	29	30					Nov 25-26: Thanksgiving Break
							Number of Student Days =19

May 2011							No School on Shaded Days
S	M	T	W	TH	F	S	
1	2	3	4	5	6	7	May 30: Memorial Day
8	9	10	11	12	13	14	
15	16	17	18	19	20	21	
22	23	24	25	26	27	28	
29	30	31					Number of Student Days = 21

December 2010							No School on Shaded Days
S	M	T	W	TH	F	S	
			1	2	3	4	
5	6	7	8	9	10	11	Dec 20-Dec 31: Winter Break
12	13	14	15	16	17	18	
19	20	21	22	23	24	25	
26	27	28	29	30	31		Number of Student Days =13

June 2011							No School on Shaded Days
S	M	T	W	TH	F	S	
			1	2	3	4	June 8 : Last Day of School
5	6	7	8	9	10	11	June 9,10,13 :Contingency Days
12	13	14	15	16	17	18	
19	20	21	22	23	24	25	
26	27	28	29	30			Number of Student Days =6

1st- 43, 2nd- 46, 3rd-44, 4th -47

Nevada Writing Proficiency Examination

Grade 8 Holistic Rubric

SCORE "SIX"	SCORE "FIVE"	SCORE "FOUR"
<p>A six paper is superior. It demonstrates skillful and purposeful control. It exemplifies ALL OR MOST of the following:</p> <ul style="list-style-type: none"> • Focuses and develops insightful ideas in a detailed, sustained, and compelling manner • Organizes ideas coherently and logically, using structure to enhance the main idea • Demonstrates sustained commitment to the topic; uses word choice with purpose and control to engage the audience • Commits few, if any, errors in Standard English grammar/usage and mechanics; uses multiple sentence structures that enhance stylistic effect 	<p>A five paper is clearly above average. It goes beyond the predictable and is controlled. It displays ALL OR MOST of the following:</p> <ul style="list-style-type: none"> • Focuses and develops ideas in an effective and detailed manner, using clear, relevant examples, explanations, and/or information • Organizes ideas coherently and logically, using a structure that supports the main idea • Communicates commitment to the topic; uses effective word choice to involve the audience • Commits few errors in Standard English grammar/usage and mechanics; uses varied sentence structures that contribute to style 	<p>A four paper is adequate or satisfactory. It exhibits ALL OR MOST of the following characteristics:</p> <ul style="list-style-type: none"> • Focuses and develops ideas with mostly relevant information, explanations, and/or examples • Organizes ideas in a satisfactory manner, using reasonable coherence and logic • Communicates some commitment to the topic; uses adequate word choice to address audience and purpose • Commits some errors in Standard English grammar/usage and mechanics that do not impede meaning; uses varied but generally predictable sentence structures
<p>A three paper is inadequate. It shows a limited or inconsistent understanding of writing. It illustrates SOME OR ALL of the following:</p> <ul style="list-style-type: none"> • Focuses on the topic, but may display irrelevant examples, explanations, and/or information • Displays some organization, shows some digression or rambling, lacks logic and coherence • Demonstrates inconsistent commitment to the topic; attempts to involve the audience; uses simplistic, imprecise, or improper words • Commits consistent violations in Standard English grammar/usage and mechanics that may impede meaning; uses sentence structure that is limited and/or simplistic 	<p>A two paper is very weak. It reveals serious and persistent problems in communication. It illustrates SOME OR ALL of the following:</p> <ul style="list-style-type: none"> • Attempts to address the topic with little or no focus; lists examples, explanations, and/or information; shows vague or no support; repetitious • Contains serious flaws in structure, organization, and coherence • Attempts but does not involve the audience appropriately; uses limited or inappropriate word choice • Commits consistent violations in Standard English grammar/usage and mechanics that often impede meaning; uses sentence structure that is very limited, simplistic, and/or incorrect 	<p>A one paper is extremely weak. It has few redeeming qualities. It at least mentions the topic, but generally fails to communicate with the reader. It illustrates SOME OR ALL of the following:</p> <ul style="list-style-type: none"> • Repeats the topic with no details, examples, or explanations • Shows little or no structure, organization, or coherence • Fails to address the audience; uses very limited word choice • Overwhelms the reader with serious violations of Standard English grammar/usage and mechanics; uses sentence structure that is limited or non-existent

The primary purpose of this rubric is to score the Grade 8 Nevada Writing Proficiency Exams. However, classroom teachers should use the rubric to ensure that students are familiar with the evaluation criteria used on the exams and to improve student writing.



My CRT Plan

Name: _____ Today's Date: _____
Date of Conference with my teacher: _____ Teacher: _____

All about Math

1. My total Math test scaled score for the 2010 CRT was _____.
2. To score at grade level on CRTs, I need to score at least _____. My score is in the following achievement level. (Circle One)

Exceeds Standards	Meets Standards	Approaches Standards	Emergent/ Developing
----------------------	--------------------	-------------------------	-------------------------

3. According to the report, the year I had my best math score ever was: _____.

I think I scored highest that year because... _____.

Circle higher or lower:

4. My Math score in 2010 was Higher/Lower than my 2007 score.
5. My Math score in 2010 was Higher/Lower than my 2008 score.
6. My Math score in 2010 was Higher/Lower than my 2009 score.

BRAINSTORM!

Think of three things to do between now and March 1st to score even higher on Math CRTs this year. Be prepared to share one of these ideas with the class.

-
-
-

All about Reading and Writing

1. My total Reading test scaled score for the 2010 CRT was _____.
2. To score at grade level on CRTs, I need to score at least _____. My score is in the following achievement level. (Circle One)

Exceeds Standards	Meets Standards	Approaches Standards	Emergent/ Developing
----------------------	--------------------	-------------------------	-------------------------

3. According to the report, the year I had my best math score ever was: _____.

I think I scored highest that year because... _____.

Circle higher or lower:

4. My Reading score in 2010 was Higher/Lower than my 2007 score.
5. My Reading score in 2010 was Higher/Lower than my 2008 score.
6. My Reading score in 2010 was Higher/Lower than my 2009 score.

BRAINSTORM!

Think of three things to do between now and March 1st to score even higher on Reading CRTs this year. Be prepared to share one of these ideas with the class.

-
-
-

This section is especially for 8th grade students!

This year, you will take the Writing Proficiency Exam in February and CRT Science test in March with the other sections of the CRT.

Please answer the following questions about the Writing Proficiency Exam.
Scoring for the writing exam is different than scoring for CRTs.

Exceeds Standards (16-20)	Meets Standards (12-15)	Approaches Standards (8-11.5)	Emergent/ Developing (0-7.5)
------------------------------	----------------------------	----------------------------------	---------------------------------

In 5th grade, my score was _____, so my achievement level was _____.

What are two things you have done this year in class to improve your writing?

1. _____
2. _____

Make a prediction about your writing exam score this year. I think my writing score this year will be a _____ because... _____

All about Science

In 5th grade, my Science CRT score was _____. What was your Achievement level? _____

What is one question you could ask your science teacher about the 8th grade Science CRT?

1. _____

Please leave this section blank until you meet with your teacher.

Teacher conference notes:

Student signature: _____

Parent signature: _____

Teacher signature: _____